



engineering catalogue 2008

SPLINE CLUTCHES

SPLINE CLUTCHES

These consist of two mating components with internal and external involute splines for clutch engagement. The leading edge of each spline is pointed to assist in the engagement, which should occur when the unit is stationary or rotating very slowly.

The sliding component is the Body 'A' which has an operating groove in the outside diameter. This can be used with either a Plain Hub 'D' or Flanged Hub 'F'.

The clutches are made from mild steel and for more severe applications may be case hardened and tempered at 220°C.

The maximum torque, which can be transmitted by the clutch, is generally limited by the size of shaft and key used to drive it and the selection of clutch should normally be made on this basis.

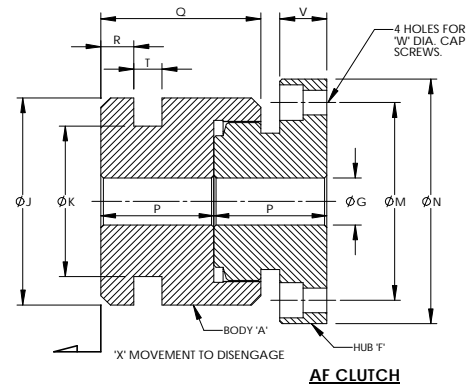
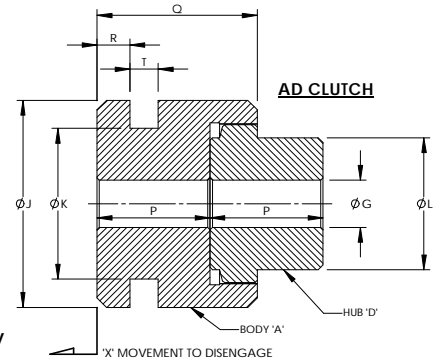

Cat. No.	Max. Bore	G	J	K	L	M	N	P	Q	R	T	V	W	X
SH 15	0.750"	0.375"	2.1/4"	1.5/8"	1.1/4"	2"	2.500"	1.1/4"	1.3/4"	3/8"	5/16"	1/2"	1/4"	3/8"
	19	9.53	57.2	41.3	31.7	50.8	63.50	31.7	44.4	9.5	7.9	12.7	6.3	9.5
SH 20	1.062"	0.625"	2.3/4"	2"	1.3/4"	2.5/8"	3.250"	1.1/2"	2.1/8"	7/16"	3/8"	5/8"	5/16"	1/2"
	27	15.88	59.9	50.8	44.4	66.7	82.55	38.1	54.0	11.1	9.5	15.9	7.9	12.7
SH 25	1.375"	0.750"	3.1/4"	2.1/2"	2.1/4"	3.1/4"	4.000"	1.3/4"	2.1/2"	1/2"	7/16"	3/4"	3/8"	5/8"
	35	19.05	82.6	63.5	57.1	82.5	101.60	44.4	63.5	12.7	11.1	19.0	9.5	15.9
SH 30	1.750"	1.000"	3.3/4"	3"	2.3/4"	3.3/4"	4.625"	2"	2.7/8"	9/16"	7/16"	7/8"	7/16"	3/4"
	45	25.40	95.3	76.2	69.8	95.2	117.48	50.8	73.0	14.3	11.1	22.2	11.1	19.0
SH 40	2.375"	1.250"	5"	4.1/4"	3.3/4"	5"	6"	2.3/4"	3.7/8"	5/8"	1/2"	1"	1/2"	7/8"
	60	31.75	127	108	95	127	152.40	69.9	98.4	15.9	12.7	25.4	12.7	22.2

Dimensions in Inches and mm.